

CONTRACTOR(S) SHALL VERIFY EXISTING CONDITIONS AND CORRELATE DIMENSIONS PRIOR TO PROVIDING THE WORK DETAILED IN THESE DRAWINGS, AND SHALL PROMPTLY NOTIFY THE DESIGNER OF ANY DISCREPANCIES. IT IS A VIOLATION OF THE LAW FOR ANY PERSON, UNLESS ACTING UNDER THE DIRECTION OF A LICENSED ARCHITECT TO ALTER THESE PLANS AND SPECIFICATIONS. THIS DOCUMENT CONTAINS PROPERTY INFORMATION AND SHALL NOT BE USED OR REPRODUCED OR ITS CONTENTS DISCLOSED, IN WHOLE OR IN PART, WITHOUT THE PRIOR WRITTEN CONSENT OF GALLO HERBERT ARCHITECTS. COPYRIGHT 2018 GALLO HERBERT ARCHITECTS

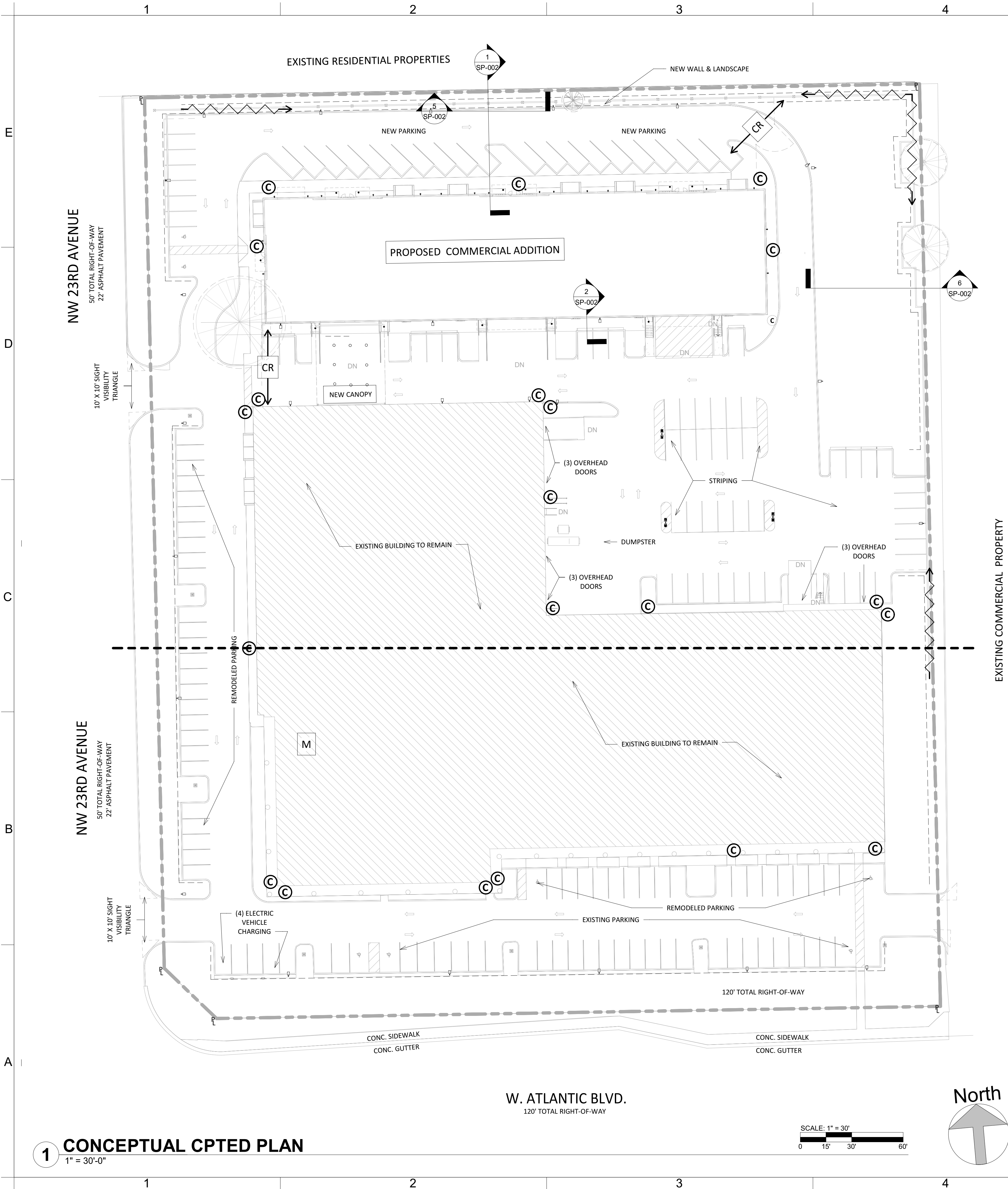

1 CONCEPTUAL CPTED PLAN
1" = 30'-0"

- 1) CPTED PRINCIPLE #1 NATURAL SURVEILLANCE
- THERE ARE WINDOWS IN THRUOUT THE FRONT FACILITY. EMPLOYEES CAN OBSERVE VISITORS ENTERING FROM THE STREET INTO THE PARKING LOT FROM THE EXISTING WINDOWS AND EXTERIOR COVERED AREAS. THE LIGHTING PLAN WILL PROVIDE EXCELLENT ILLUMINATION TO THE EXTERIOR OF THE BUILDINGS, DELIVERY AREAS, PARKING SPACES AND VEHICULAR ENTRANCES FOR GOOD VISIBILITY AND ACCOUNTABILITY.
- 2) CPTED PRINCIPLE #2 NATURAL ACCESS CONTROL
- ACCOMPLISHED BY HAVING VEHICULAR GATES AND CHAIN LINK FENCES TO PREVENT ACCESS TO DELIVERY AREA BEHIND THE BUILDINGS AFTER NORMAL DELIVERY HOURS TO CREATE OPEN VISIBILITY FOR EMPLOYEES, STAFF AND VIDEO SURVEILLANCE.
 - THERE WILL BE VIDEO SURVEILLANCE AT THE VEHICLE ENTRANCES, WORKING AREAS AND PARKING LOTS.
 - *NOTE: VIDEO SURVEILLANCE SYSTEM SHOULD BE A FIXED LENS AND NOT PAN TILT AND ZOOM, WEATHER PROOF AND VANDAL RESISTANT.
- 3) CPTED PRINCIPLE #3 TERRITORIAL REINFORCEMENT
- GROUND PLANTING AND HEDGES SHOULD BE LESS THAN 3 FEET AND TREE CANOPIES OVER 8 FEET TO ALLOW CLEAR ZONE OF NATURAL SURVEILLANCE FOR POLICE TO BE ABLE TO HAVE UN-OBSERVED SIGHT AROUND THE PERIMETER AND INTO THE PROPERTY.
- 4) CPTED PRINCIPLE #4 MAINTENANCE
- TREE CANOPIES SHOULD BE MAINTAINED CLEAR UNDER 8 FEET, WITH A TREE TRUNK SIX INCHES IN DIAMETER OR GREATER.
- 5) CPTED PRINCIPLE #5 ACTIVITY SUPPORT
- MAIN ANCHOR STORE IS CURRENTLY OPERATING DURING THE WEEK FROM MONDAY TO SATURDAY FROM 8:30 AM TO 5:00 PM. SUNDAY FROM 11:00 AM TO 5:00 PM.
- THE SITE PLAN EXPANSION HAS PLANNED TO IMPROVE THE SECURITY FUNCTIONS FOCUSED ON THE SITE.
 - GROUND RULES WILL BE SUPPLEMENTAL TO SPELL OUT CLEARLY THE RULES OF UNAUTHORIZED ACCESS AND TRESPASS.
 - THE ACTIVITY SUPPORT FROM HAVING A NUMBER OF EMPLOYEES WORKING ON THE SITE AROUND THE CLOCK IS THE STRONGEST DETERRENT TO CRIME ON AND AROUND THE PROPERTY.
 - THE EMPLOYEES SERVE AS CAPABLE GUARDIANS OF THE PROPERTY AND CAN CHALLENGE TRESPASSERS AND CALL POLICE FOR QUICK RESPONSE.

2 CPTED PRINCIPLES

CRIME PREVENTION & CPTED PUBLIC SAFETY / SECURITY DRAWING LEGEND		
SN:	SURVEILLANCE NATURAL	
SE:	SURVEILLANCE ELECTRONIC (FIXED LENS CAMERA)	
ACN:	ACCESS CONTROL - NATURAL	
ACP:	ACCESS CONTROL - PHYSICAL (BUILT) PROVIDED GATES TO SECURE LOADING BACK LOT AFTER HOURS	
TR:	TERRITORIAL REINFORCEMENT DEFINED PERIMETER LANDSCAPE	
M:	MAINTENANCE ON SITE MAINTENANCE LOCATION	
AS:	ACTIVITY SUPPORT ACTIVITY THROUGHOUT WEEK - LOCATIONS	
NOTE: CPTED & CRIME PREVENTION SECURITY CONCEPTS COMPLEMENT EACH OTHER AND OVERLAP. EXAMPLE SN CAN OVERLAP WITH TR & AS, ETC.		

GENERAL DEFENSIBLE SPACE NOTES:

·THE NEW SITE PLAN IS PROPOSING A VEHICULAR AND PEDESTRIAN ACCESS, WARNING AND GROUND RULE SIGNAGE, SITE VIDEO SURVEILLANCE, IMPROVED SITE LIGHTING, WHICH WILL IMPROVE SAFETY SECURITY TO THE FACILITY AND OPERATIONS.

GENERAL PROPERTY NOTES:

18"x24" BROWARD COUNTY NO TRESPASSING SIGNS TO BE USED.

ALL PARKING SPACES SHALL BE ASSIGNED AND MARKED FOR AUTHORIZED EMPLOYEES.
SECURITY CAMERAS RECOMMENDED TO FULLY VIEW ALL NEW PARKING LOT AREAS AND BUILDING ENTRANCES

SITE LIGHTING MEETS SECURITY SAFETY STANDARDS.



AA26001731
[SEAL]
WILLIAM J. GALLO FL AR0008440
Digitally signed by Brian Herbert
Date: 2022.07.05 14:38:03 -04'00'
BRIAN P. HERBERT FL AR0015474
[PROJECT]

FIBERBUILT
UMBRELLA

2201 LLC

2201 WEST ATLANTIC BLVD
POMPAHO BEACH, FL 33069

OWNER



REVISIONS

No.	Description	Date
2	INTERNAL COORDINATION	11/18/2021

PROJECT STATUS
SCHEMATIC
DESIGN

DATE

Aug. 30, 2021

PROJECT NUMBER

2321

DRAWN BY: M.L.B. CHECK BY: J.E.T.

SCALE

AS NOTED

DRAWING TITLE

CPTED PLAN

DRAWING NUMBER

CPTED-1

DRC
PZ21-12000052
8/17/2022